

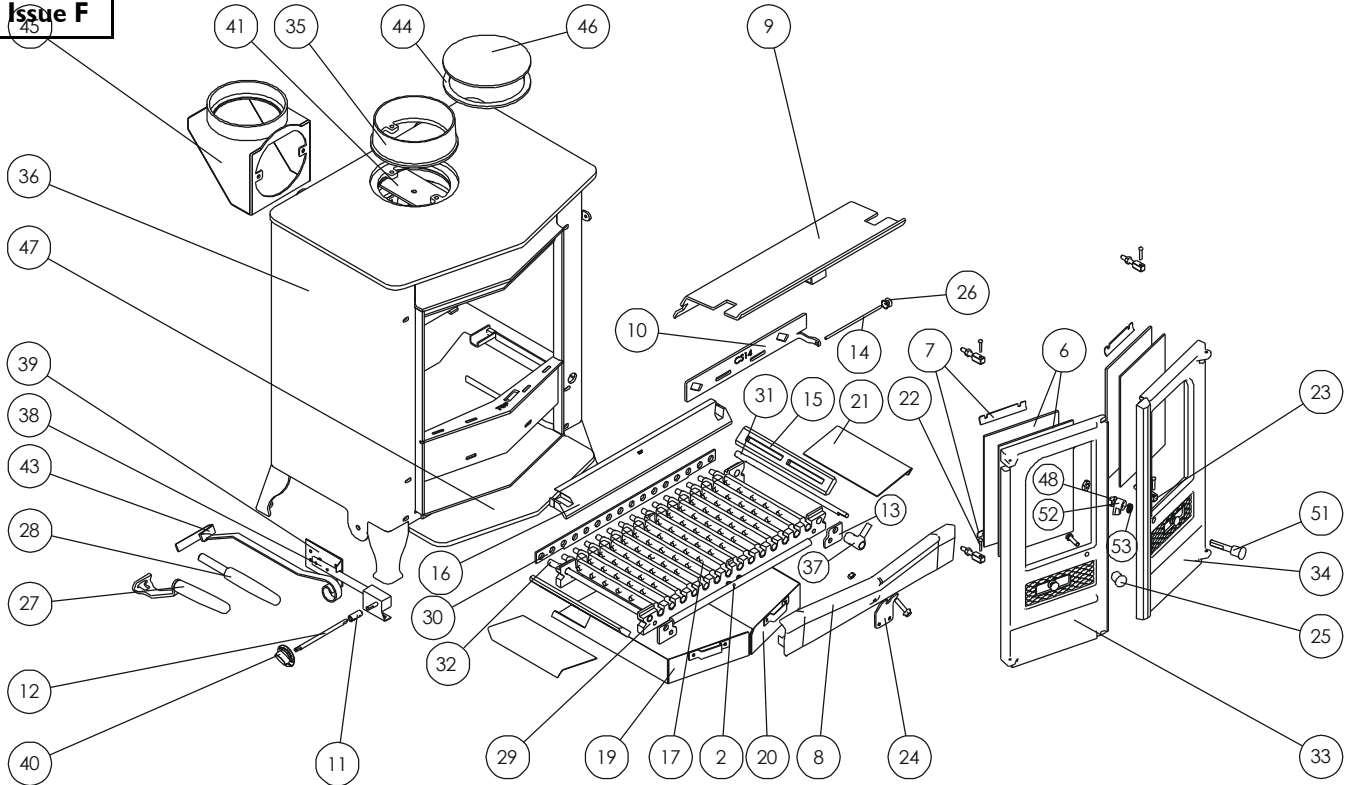

Issue F



Item	Part No.	Description	Ex.Vat.	Inc.Vat.	Item	Part No.	Description	Ex.Vat.	Inc.Vat.
2	008/CS13	Front Rope Seal	14.30	17.16	28	012/BV36/A	Riddling Tool	24.50	29.40
3*	008/FV35/S	Door Seal Set Incl. Adhesive	30.00	36.00	29	002/BV30	Carrier Bar	72.00	86.40
4*	008/FW29	Door Seal Adhesive	11.20	13.44	30	012/BV33	Mover Bar	62.00	74.40
5*	008/TW75	Glass Seal Kit	14.90	17.88	31	012/BV37	Riddler Rod	35.50	42.60
6	006/LW30	Glass (Inc Seal)	36.50	43.80	32	012/CG05	Idler Rod	34.50	41.40
7	004/EW23	Glazing Bar	4.05	4.86	33	002/FV01	Left Hand Door	118.00	141.60
8	002/CS07	Wood Retainer	76.00	91.20	34	002/FV02	Right Hand Door	118.00	141.60
9	010/CS31	Throat Plate	73.00	87.60	35#	002/CH12B	Flue Collar	73.00	87.60
10	012/CS14	Secondary Air Slide	14.00	16.80	36	009/CO16BWB/A	Firebox / Boiler Assy (Country 16B)		
11	004/CS18	Thermostat Connector Tube	16.80	20.16	37	002/AY27	Riddler Knob	21.50	25.80
12	004/CS16	Thermostat Rod	15.00	18.00	38	008/FW48	Thermostat	54.50	65.40
13	010/CS15	Carrier Bar Packer Plate	1.94	2.33	39	008/FV49	Thermostat Flap	10.00	12.00
14	004/CS19	Secondary Air Rod	18.90	22.68	40	008/BW50	Thermostat Knob	4.85	5.82
15	002/EW15	Side Fire Plate	34.50	41.40	41	010/AY51	Clamping Plate	19.20	23.04
16	002/BV16	Back Fire Plate	65.00	78.00	42	012/CS11W	Serial No. Label		
17	002/CG01	Bottom Grate Bar	16.90	20.28	43	012/FW34	Scraper Tool	13.20	15.84
18	002/CG01S14	Set of Grate Bars (14 Per Set)	190.00	228.00	44	008/NV38	Flue Fixing Rope Seal	7.55	9.06
19	004/FV17L	Left Hand Ashpan	79.00	94.80	45#	010/TW33	Vert. Rear Flue Connector (Opt'l Extra)	122.00	146.40
20	004/FV17R	Right Hand Ashpan	79.00	94.80	46	012/TW09	Blanking Plate	24.50	29.40
21	004/BV19	Ash Shedding Plate	16.90	20.28	47	010/CS12	Shelf	68.00	81.60
22	008/BW39/S	Hinge Pin Set	3.80	4.56	48	004/ST008	Tabbed Locking Washer	1.46	1.75
23	008/FW27	Hinge Post	6.85	8.22	49*	010/BW51	Ash Carrier (Optional Extra)	122.00	146.40
24	010/CS17	Front Fence Support Bracket	4.85	5.82	50*	008/TH02/L	Low Level Pipe Stat (Opt'l Extra)	61.00	73.20
25	002/DY19	Left Hand Door Knob	15.00	18.00	51	002/DY18	R.H. Door Knob & Spindle	21.00	25.20
26	002/TW13	Air Control Knob	18.40	22.08	52	002/AY14	Door Catch Cam	10.30	12.36
27	012/BV20/A	Ashpan / Door Opening Tool	27.00	32.40	53	008/FFW015	M12 Double Coil Spring Washer	2.20	2.64

* These items are not shown on the drawing.

Please specify colour when ordering. Prices are shown in pounds sterling with vat at 20% They are correct at the date shown but may be subject to change without notice. E. & O.E These prices are subject to a carriage charge.

To obtain spare parts please contact your local stockist giving Model, Part No. and Description. In case of difficulty contact the manufacturer at the address shown. This drawing is for identification purposes only.

