

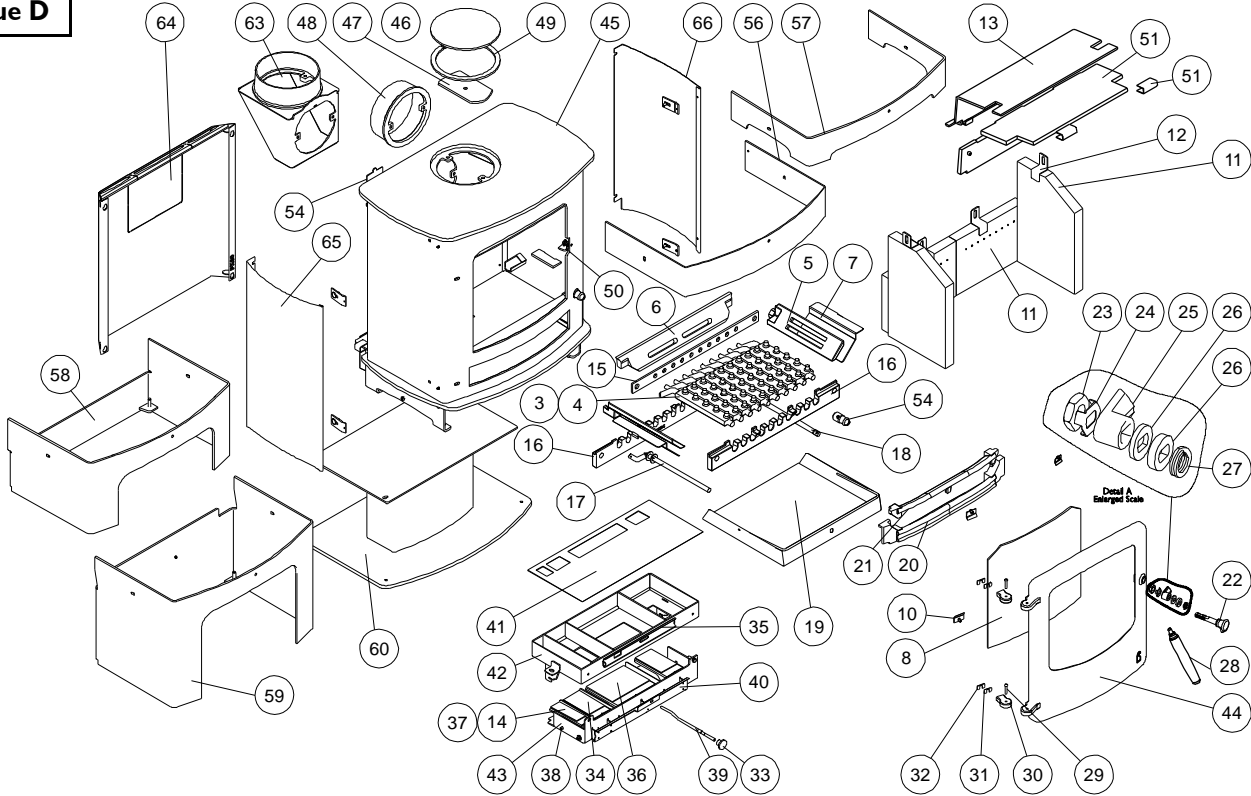

Issue D



Item	Part No.	Description	Ex.Vat.	Inc.Vat.	Item	Part No.	Description	Ex.Vat.	Inc.Vat.
1*	008/PY23S	Door Seal Set Inc.Adhesive	30.00	36.00	34	004/CY22S	Secondary Air Inlet Flap	22.00	26.40
2*	008/FW29	Door Seal Adhesive	11.20	13.44	35	004/CY21	Air Bypass Slide	21.50	25.80
3	002/CG20	Bottom Grate Bar	16.90	20.28	36	004/CY22P	Primary Air Inlet Flap	23.50	28.20
4	002/CG20S10	Set of Grate Bars (10)	138.00	165.60	37	004/AY22-1S	Secondary/Bypass Air Inlet Flap	21.50	25.80
5	002/CY15	Side Fire Plate	36.00	43.20	38	004/CY24	Flap Mounting Rod (Inc. Fixings)	11.20	13.44
6	002/AY16	Back Fire Plate	63.00	75.60	39	004/PY32	Air Control Rod	15.00	18.00
7	004/BY24	Ash Shedding Plate	16.90	20.28	40	004/HS23	Actuator Assembly	53.50	64.20
8	006/PY18	Glass (Inc Seal)	122.00	146.40	41	008/RV16	Upper Quattro Box Gasket	18.60	22.32
9*	008/PY45	Glass Seal	12.10	14.52	42	010/PY20	Upper Quattro Box	79.00	94.80
10	004/KV23	Glass Retainer	0.70	0.84	43	010/CY19	Lower Quattro Box	52.50	63.00
11	011/HS29S	Set of Fire Bricks (4)	108.00	129.60	44#	002/PY01/A	Door Assembly	260.00	312.00
12	004/XV30	Brick Retainer	7.45	8.94	45	001/HX10	Firebox (Cove2SR MkII)		
13	010/HS31	Throat Plate	64.00	76.80	46	012/TW09	Blanking Plate	24.50	29.40
14	008/CY26S	Set of Air Inlet Flap Pads	21.00	25.20	47	010/AY51	Clamping Plate	19.20	23.04
15	012/AY33	Mover Bar	48.00	57.60	48#	002/CH12B	Flue Collar	73.00	87.60
16	002/AY30	Carrier Bar	52.50	63.00	49	008/NV38	Flue Fixing Rope Seal	7.55	9.06
17	012/AY13	Idler Rod	34.50	41.40	50	010/PY38	Door Catch Stop	3.55	4.26
18	012/AY15	Riddler Rod	35.50	42.60	51	011/HS39S	Set of Throatplate Bricks & Clips (2)	30.50	36.60
19	004/PX17	Ashpan	77.00	92.40	52*	004/HS11	Bypass Cover Plate	10.20	12.24
20	002/AY07B	Front Firebar	57.00	68.40	53*	004/HS12	Main Air Restrictor		
21	002/AY08	Deepening Bar	51.00	61.20	54	002/PX89	Riddler Knob	36.00	43.20
22	002/PX92	Door Knob & Spindle	23.50	28.20	55	012/HS19	Serial No. Label	NA	
23	008/FFN001	M12 Half Nut	0.21	0.25	56#	010/PY36	Low Stand	75.00	90.00
24	004/ST008	Tabbed Locking Washer	1.46	1.75	57#	010/PX32	Low Arch Stand	75.00	90.00
25	002/AY14	Door Catch	10.30	12.36	58#	010/PX35	Midi Stand	182.00	218.40
26	010/ST031	Door Catch Spacer	2.10	2.52	59#	010/PY33	Store Stand	205.00	246.00
27	008/FFW015	M12 Double Coil Spring Washer	2.20	2.64	60#	010/PY34	Centre Stand	146.00	175.20
28	008/PX95	Door/Riddling/Ashpan Tool	35.50	42.60	61*	010/PY52A	External Air Manifold Kit (Opt'l Extra) ..	NA	
29	008/BW39/S	Hinge Pin Set	3.80	4.56	62*	010/BW51	Ash Carrier (Optional Extra)	122.00	146.40
30	002/PY24	Hinge Post	16.50	19.80	63#	010/TW33	Vert. Rear Flue Connector (Opt'l Extra)	122.00	146.40
31	004/PY25B	Hinge Post Shim 0.9mm	0.52	0.62	64#	010/PX80	Heatshield (Opt'l Extra)	83.00	99.60
32	004/PY25A	Hinge Post Shim 2mm	0.52	0.62	65#	005/PX93L	LH Curved Side Panel (Opt'l Extra)	26.05	31.26
33	008/AY37	Air Control Knob	4.85	5.82	66#	005/PX93R	RH Curved Side Panel (Opt'l Extra)	26.05	31.26

* These items are not shown on the drawing

Please specify colour when ordering. Prices are shown in pounds sterling with vat at 20% They are correct at the date shown but may be subject to change without notice. E. & O.E These prices are subject to a carriage charge

To obtain spare parts please contact your local stockist giving Model, Part No. and Description. In case of difficulty contact the manufacturer at the address shown. This drawing is for identification purposes only.

